

Contents

Operation	1
Cartridge drop lever operation	1
Assembly (from packaged gun)	2
Safety	7
Telescoping stock adjustment	7
Loading	8
Cartridge replacement	11
Unloading	13
Gun stripping	15
Firearm cleaning	24
Shotgun assembly	24
Trouble shooting	31
Choice of ammunition	31
Rear sight adjustment	31
Windage adjustment	31
Elevation adjustment	32
Internal choke (when supplied)	33
Three round limiter	36

SAFETY RULES

The safety warnings contained in this booklet are an important reminder to whomever owns or utilises firearms.

Firearms, if not handled correctly, can be dangerous, and have the potential to cause serious and irreparable damage.

- 1) **Never point** a firearms at anyone, or in any direction other than a SAFE direction, i.e., downrange.
- 2) Always handle firearms as **if they were loaded**.
- 3) Keep your finger **off the trigger** until the target is in view.
- 4) **Never fire** the combat shotgun **without the forearm installed**, both right and left halves.
- 5) Keep the gun's **safety on** and finger **away from the trigger** during loading or unloading of the gun.
- 6) **Before firing** at the target, ensure that no person, animal, or other object that could be hit is behind or near the target.
- 7) **Never give or take from anyone** an arm that doesn't have the **breech open**.
- 8) During the loading of ammunition, follow scrupulously **the directions** in this booklet and **ensure** that the ammunition is in **perfect condition**.

- 9) Before using, with **the gun unloaded** and the action locked open, check that **the barrel** of the shotgun **is clear** of any obstruction.
- 10) Before shooting an unfamiliar gun, be sure that you understand completely its functioning: lack of experience can be the cause of serious accidents.
- 11) When firing, it is advisable to wear ear and eye protection.
- 12) Always keep hands and fingers away from the muzzle of the gun, to avoid wounds or burns.
- 13) Firearms and ammunition should always be stored separately, and locked, well away from children's reach.
- 14) Do not drink alcoholic beverages before or during the use of firearms.

REMEMBER:

PAY CLOSE ATTENTION TO HOW YOU HANDLE YOUR GUN: ACCIDENTS ALMOST ALWAYS RESULT FROM FAILURE TO OBSERVE THE FUNDAMENTAL SAFETY RULES.

Operation

Before attempting any work on your M4 make sure that the chamber and the magazine of your shotgun are unloaded. (See the instructions on loading and unloading on pages 8-13).

The M4 shotgun is a semi-automatic, tubular magazine fed weapon chambered for the 12 gauge (18.4 mm) shotshell cartridge. The operating system employed in this weapon is the improved **ARGO (Auto-Regulating Gas Operated) Twin** (two gas pistons/cylinders/ports) **System** with rotating bolt head with dual locking lugs.

There are eight general steps in the operating cycle of M4:

firing	squeezing the trigger releases the cocked hammer which strikes the firing pin igniting the primer and the propellant within the shell. The expanding gases exert pressure on all sides of the shell casing, driving the projectile forward down the bore. An equal amount of force is intercepted in the gas system
unlocking	actuation of the breech mechanism that results in the opening of the chamber
extraction	removal of the cartridge case from the chamber
ejection	expulsion of the cartridge case from the weapon
cocking	the resetting of and storage of energy in the mechanism which provides the energy needed to ignite the primer of the live, chambered cartridge

feeding the transference of the live cartridge from the feed mechanism in the direction of the chamber

chambering the insertion of the live cartridge into the chamber of the weapon

locking the actuation of the breech mechanism that results in the closing, and sealing, of the chamber.

The shotgun is now ready to be fired.

Cartridge drop lever operation

The feeding system operates by means of a special **cartridge drop lever**, the outer portion of which protrudes below the receiver and is thus easily reached by the trigger finger.

The hammer spring forces the cartridge drop lever upwards to disengage it from the carrier latch which, pulled by the carrier latch spring, rotates clockwise to allow a cartridge to exit from the magazine. As the cartridge falls into position on the carrier, it presses against the cartridge drop lever which rotates in the opposite direction to prevent a second cartridge from exiting. The end of the cartridge drop lever which protrudes from the receiver is marked with a red point. When the red point is visible, the hammer is cocked and the gun is ready to fire; otherwise the hammer is not cocked.

Assembly (from packaged gun)

Components of the package

stock-receiver-bolt
barrel-breech
half-fore-end
bolt handle

Procedure

- 1) Insert completely the **bolt handle** into the breech bolt unit (fig. 1);
- 2) unscrew the fore-end **cap** (fig. 2);

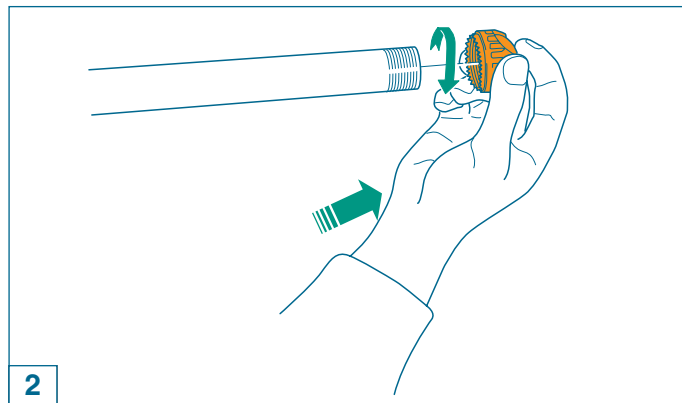
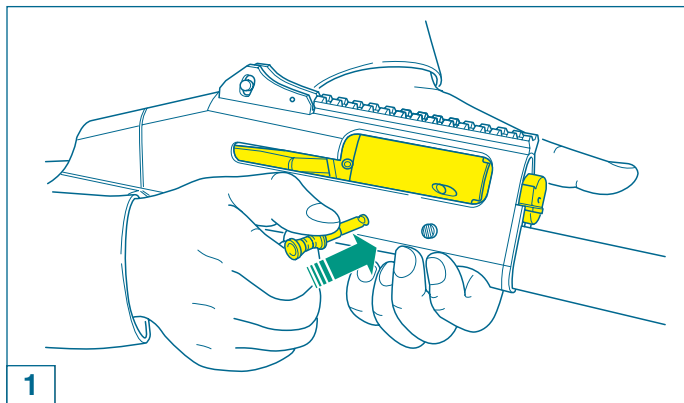

- 3) take the **stock-receiver-bolt** unit with a hand; with the other hand, using the cocking lever, bring **the bolt** into open position (until locked) (fig. 3); the cross-bolt button is set in the “fire” position.

WARNING: should the bolt **fail** to engage, **move the cartridge drop lever** as arrowed and repeat the operation (fig. 4).

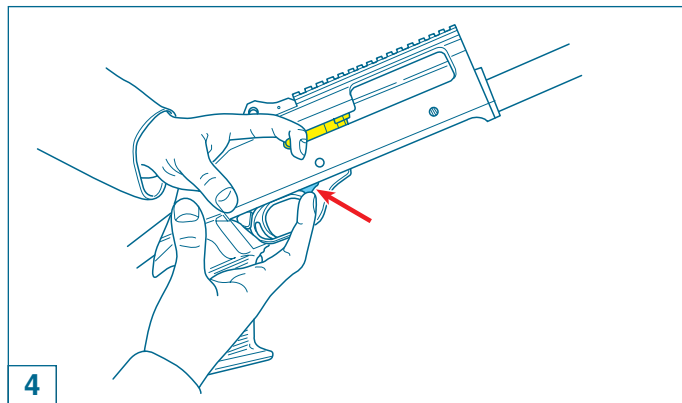
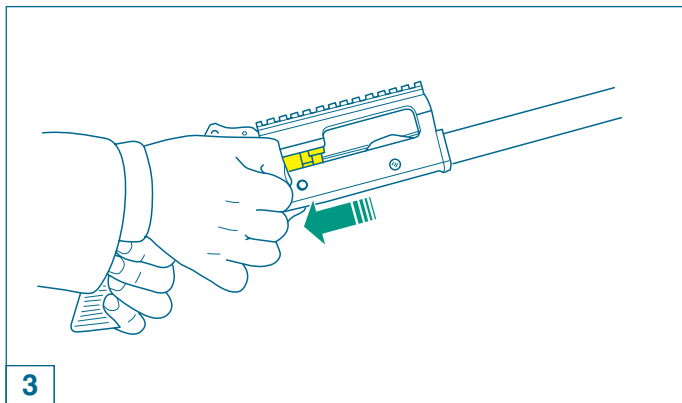

During this operation **the bolt** group should be completely assembled and placed **in the receiver, in open position** (backward).

- 4) take the **barrel-breech** unit, place the barrel on the **magazine tube** and slide it down toward the receiver (fig. 5);
- 5) insert the **breech extension** on the receiver, ensuring that **the magazine tube** enters the opening of **the barrel guide ring** (fig. 6);

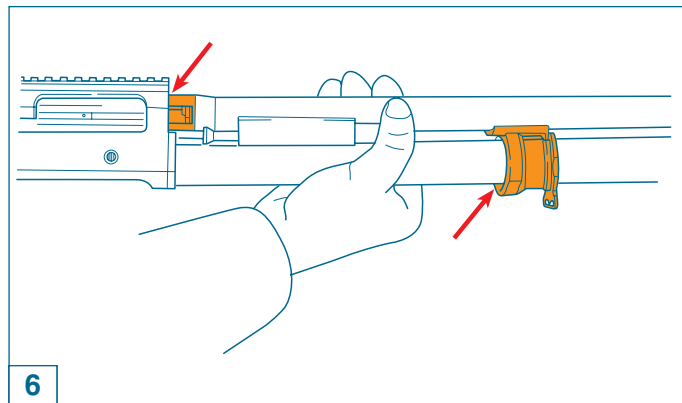
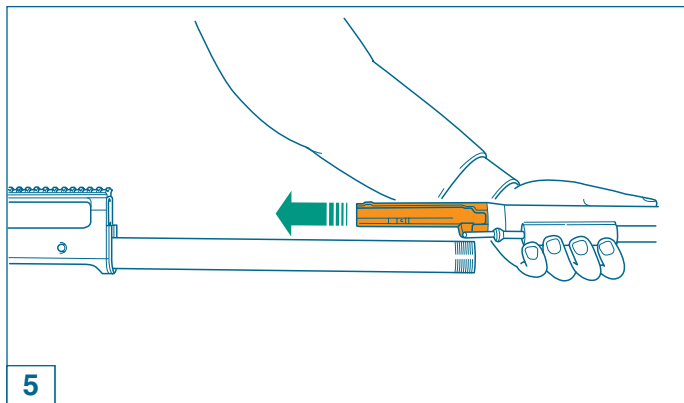

- 6) position **the twin forearms** together (fig. 7) and insert them into the retaining band on the rear barrel;

NOTE: inserting the breech **extension** on the receiver be sure that it does not strike against the bolt locking head.

- 7) with the barrel **extension** resting on the bolt head, and the **bolt head** fitting into the recess formed into the barrel extension, slip the barrel into receiver. A metallic click will indicate the barrel is correctly seated (fig. 8).

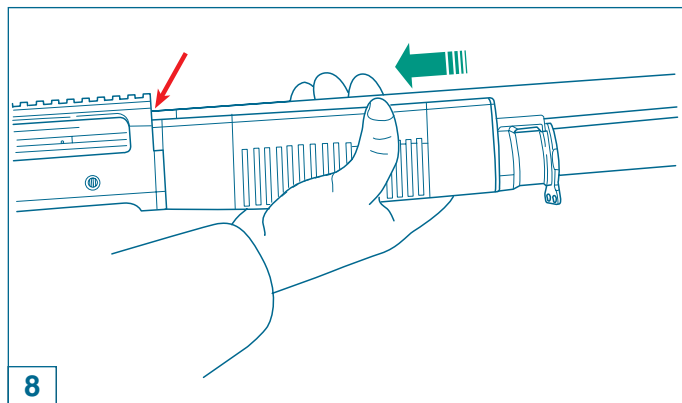
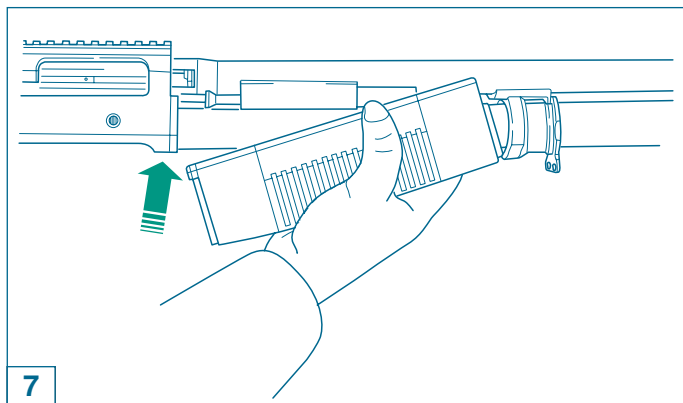

- 8) screw on the fore-end **fastening cap**, on the end of the tubular magazine and **tighten firmly** until the barrel and the fore grip are locked perfectly against the receiver (fig. 9).

*The chrome barrel extension **must be** completely contained by the receiver. None of the chromate parts must be visible at the front of the receiver (fig. 8).*

- 9) close **the bolt** by pressing the special carrier control **button** (fig. 10).

The shotgun is now ready to be fired.

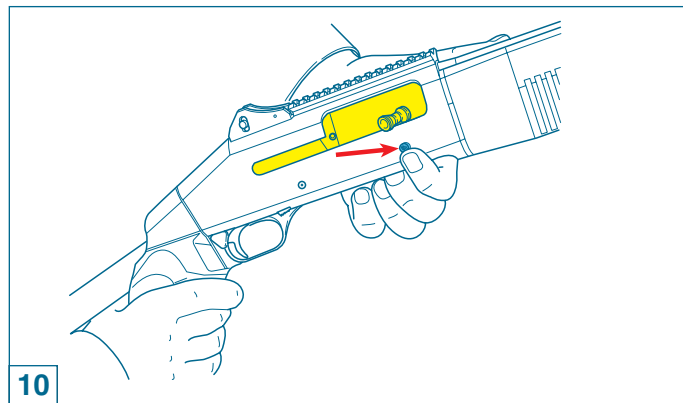
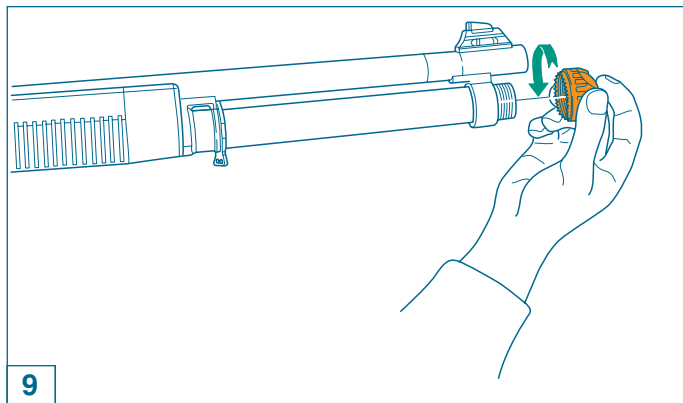

Safety

Press the **safety button** on the trigger guard until **its red ring**, indicating firing position, **is no longer visible** (figs. 11-12).

Telescoping stock adjustment

M4 is fitted with a two position **telescoping stock**:

short/extended

Starting with the telescoping stock extended and to shorten it (fig. 13):

- depress **locking button**;
- rotate the extendible stock **clockwise** (rear view);
- push it **forward** till front stop;
- rotate the stock **counter-clockwise** and release the button.

To extend the stock, follow the reverse sequence.

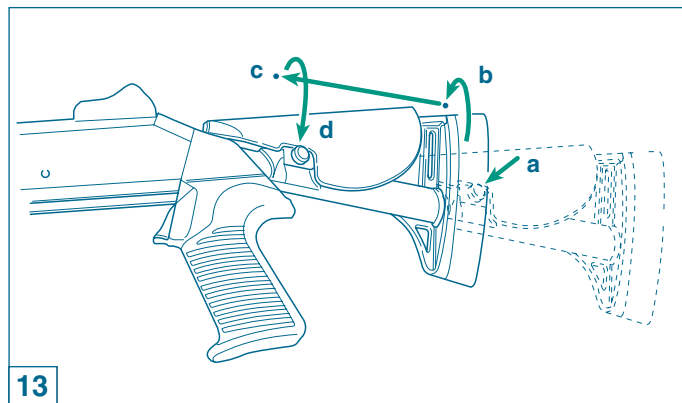
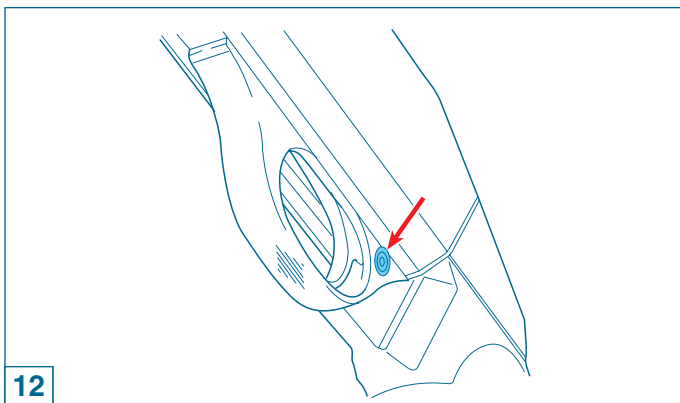
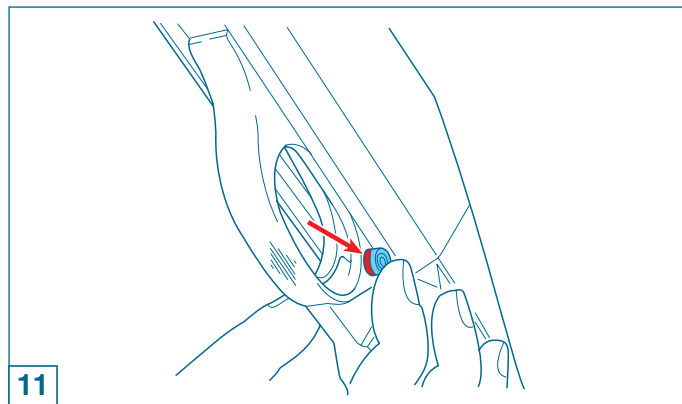

Loading

Before starting any operation on your shotgun, make sure that the chamber and the magazine are unloaded!

The magazine can hold six cartridges 76 mm (3") long, or 70 mm (2" 3/4).

Loading procedure

NOTE: Make sure that the shotgun **safety catch** (See "Safety", page 15) is engaged and the **hammer cocked** (so that the carrier latch can retain the cartridges as they are inserted in the magazine - see "Assembly procedure", point 3, page 3).

WARNING: for safety reasons, **verify** if by opening the breech bolt the shotgun is unloaded. Then close the breech bolt again.

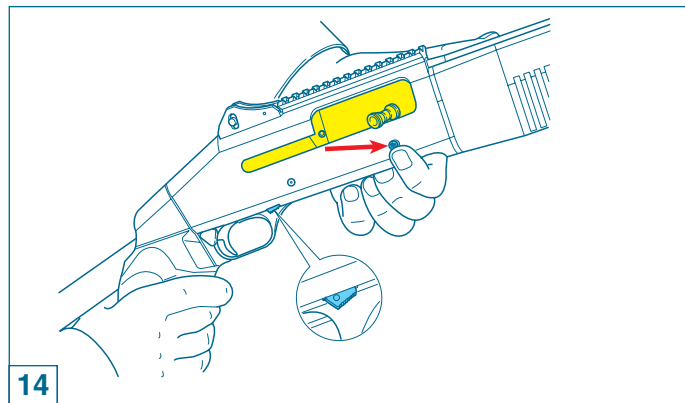

- 1) The **red dot** on the cartridge drop lever (indicating that the hammer is cocked) **must be clearly visible**. To bring lever to this position, press the carrier **button** (fig. 14) and open the **bolt** by hand, then bring it to close position again (fig. 15);
- 2) with the bolt closed and the hammer cocked, reverse the gun **pointing the barrel downwards**;

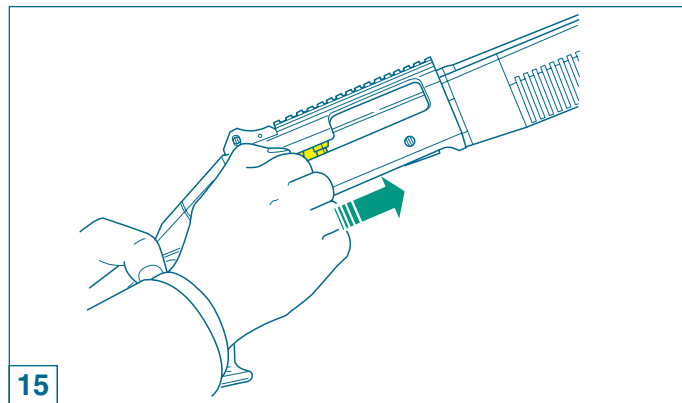

- 3) **insert a cartridge** into the magazine (fig. 16): **push** it until it is retained by the carrier latch which engages automatically (fig. 17). Repeat the operation until the magazine is fully loaded.

Now the gun cannot be fired unless a cartridge is placed in the barrel, as to one of the following procedures.

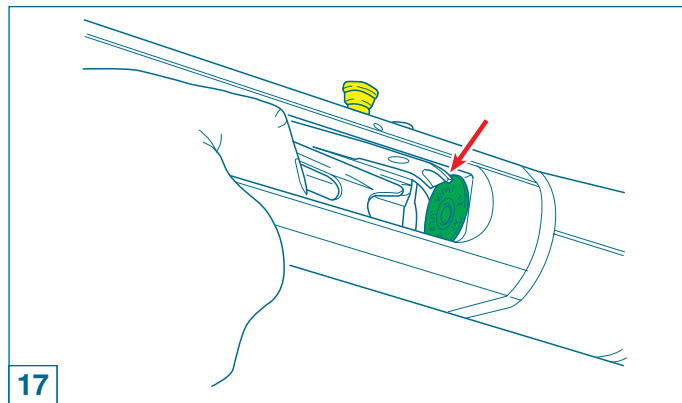
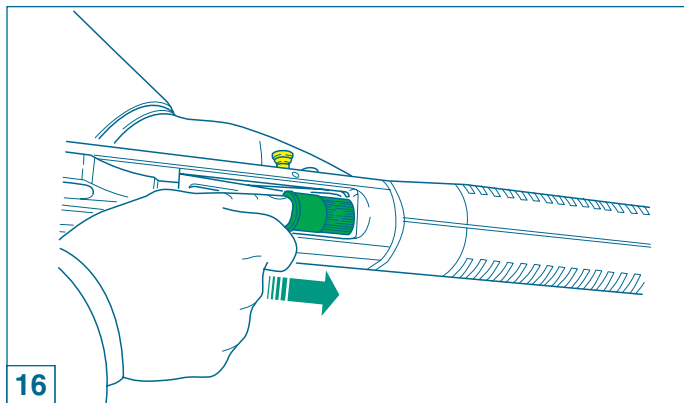

A) direct procedure:

- 1) open **the bolt** (fig. 18) and in the same time **insert** a cartridge into the barrel through the case ejection port (fig. 19);
- 2) **release** the cocking lever: the bolt will push the cartridge on the carrier into the chamber and stop in the closed position.

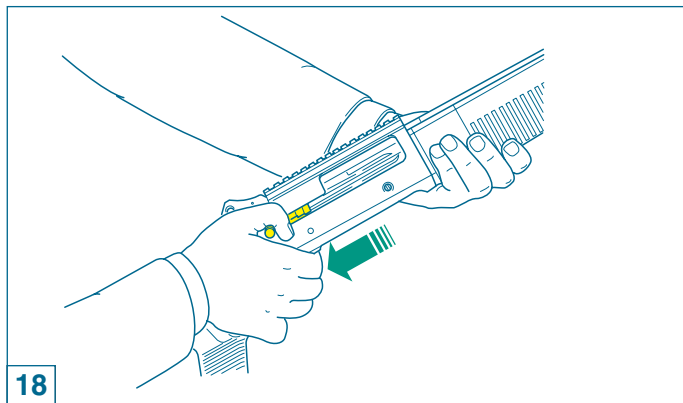
**B) indirect procedure:**

- 1) open the bolt and hold it in this position through the cocking lever. Press in the same time **the cartridge drop lever**, so that the first cartridge in the magazine drops into the carrier (fig. 20);
- 2) **release the cocking lever**: the bolt will push the cartridge on the carrier into the chamber and stop in the closed position.

WARNING: with the procedure “B” the number of cartridges in the magazine will be reduced by one round. A new cartridge can be inserted - see above - to fill the magazine completely.

NOTE: during this operation, **always point the gun in a safe direction**, even though the safety catch is engaged (see “Safety”; page 7).

Now **the gun is loaded**: when the safety catch is moved to firing position (**red ring visible**), the gun is ready for use.

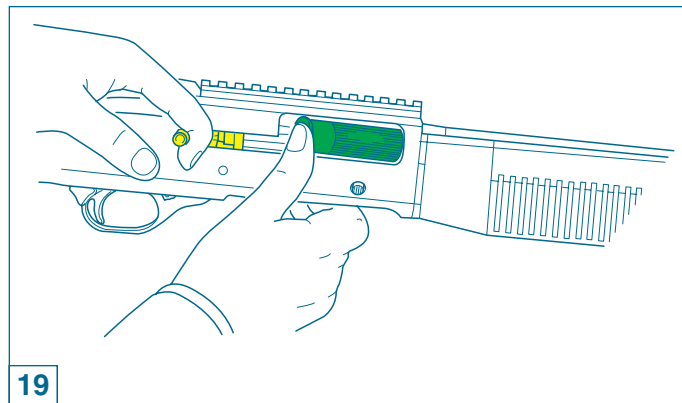

Cartridge replacement

(this operation must be carried out with the gun safety catch engaged - see “Safety”, page 7 and barrel pointed in a safe direction)

To replace a cartridge in the chamber, two procedures can be followed:

- A) by **manual replacement** of a new cartridge;
- B) by **using the cartridge drop lever**.

A) manual replacement (when the cartridge is not in the magazine)

- 1) reset the stock on your hip and pull the cocking lever **to open** the bolt: the cartridge in the chamber is extracted and ejected from the gun (fig. 21);

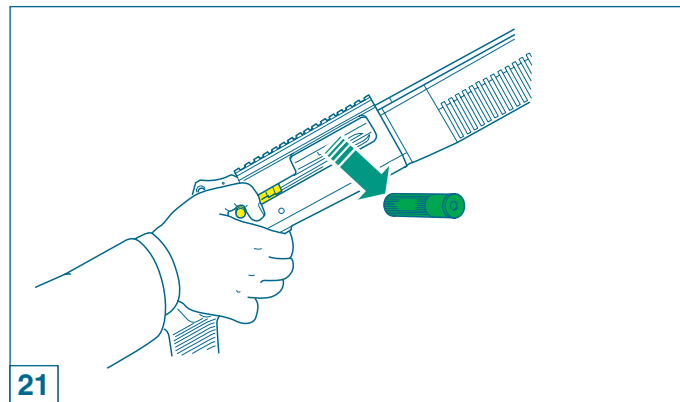
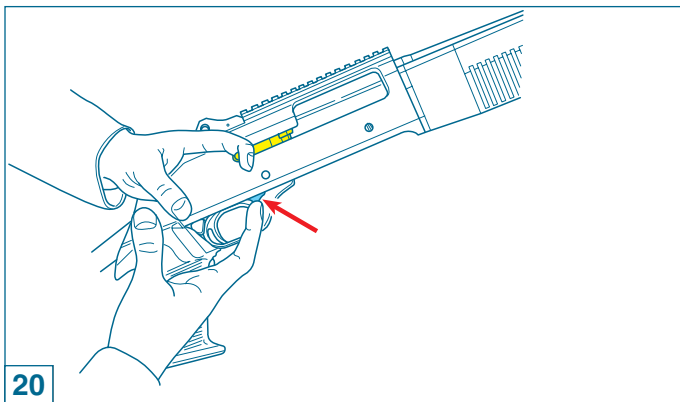

- 2) **insert** a new cartridge in the barrel through the ejection port (fig. 22) and release the cocking lever to reclose the bolt.

B) using the cartridge drop lever (when the cartridge is in the magazine)

- 1) rest the stock on your hip and **open** the bolt by hand: the cartridge in the chamber is extracted and ejected from the gun (fig. 23);
- 2) press **the cartridge drop lever** (fig. 24). Release the cocking lever to reclose the bolt. In this way, the cartridge will pass quickly from the magazine to the chamber .

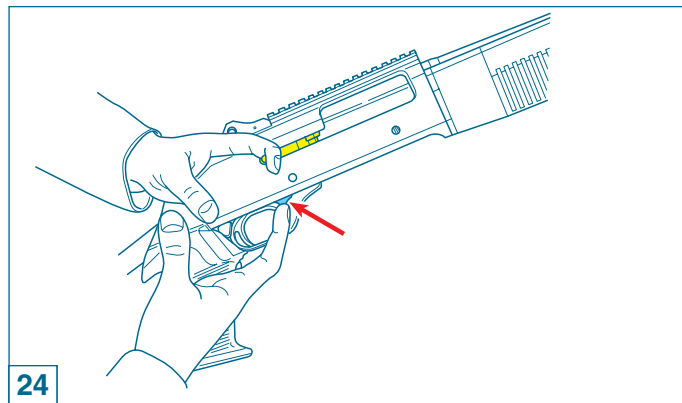
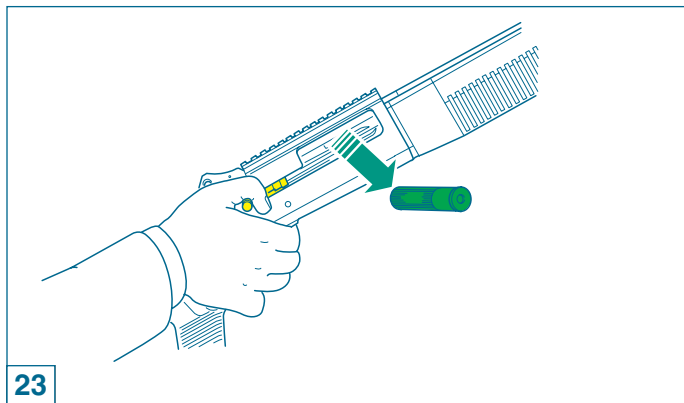
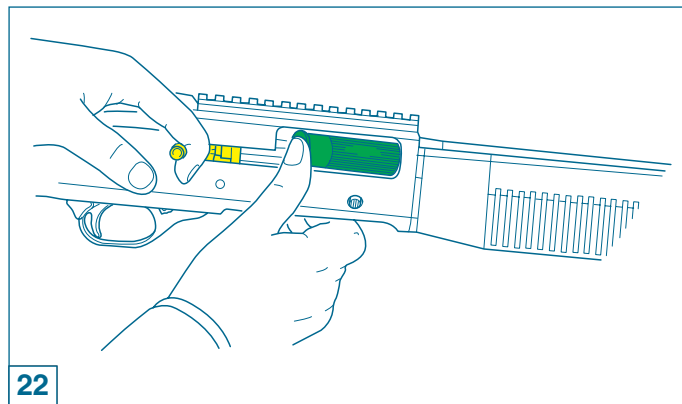

Unloading

(this operation must be carried out with the gun safety catch engaged - see "Safety", page 7 and the barrel pointed in safe direction)

To unload the shotgun, proceed as follows:

- 1) **open the bolt:** the cartridge in the chamber will be extracted and ejected (fig. 25);
- 2) **close the bolt:** gently releasing the clocking lever (fig. 26);

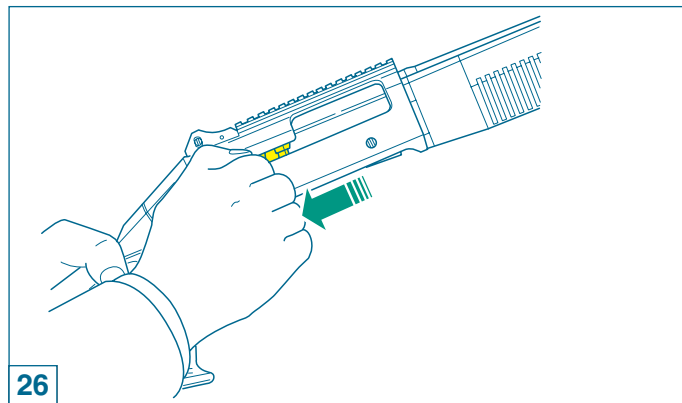
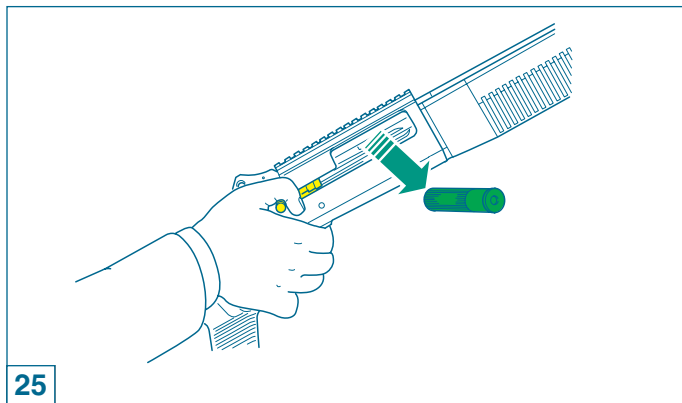

- 3) reverse the gun and - thrusting the carrier towards inside - **press the cartridge retaining lever** from the front with the right hand index finger (fig. 27); the first cartridge will come out. The carrier latch must be pressed for each released cartridge.

WARNING: Gun can be unloaded by repeating the operation, as described under point B, this section above, of the chapter: "**Cartridge replacement**".

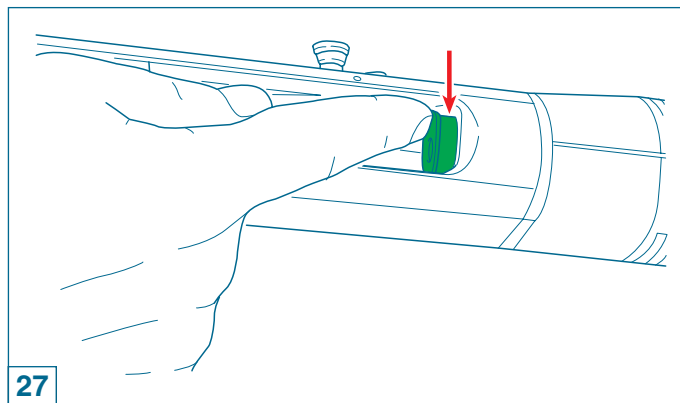

Gun stripping

Before attempting any work on your M4 make sure that the chamber and the magazine of your shotgun are unloaded. (See the instructions on loading and unloading on pages 8-13).

M4 is a modular-style shotgun: no armorer tools are required for its stripping.

Stripping procedure

- 1) open **the bolt** (fig. 28);
- 2) move the **cartridge drop lever** (fig. 29);

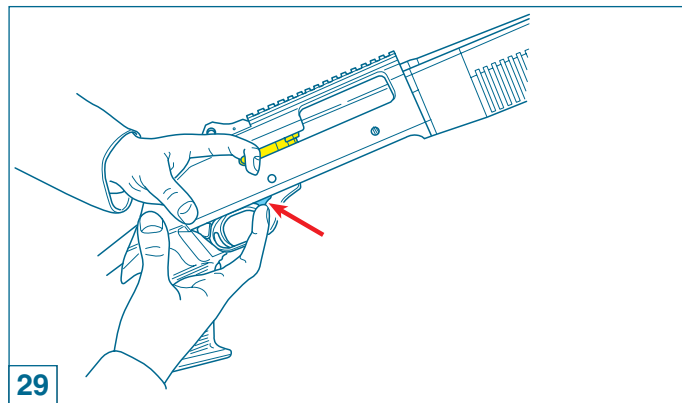
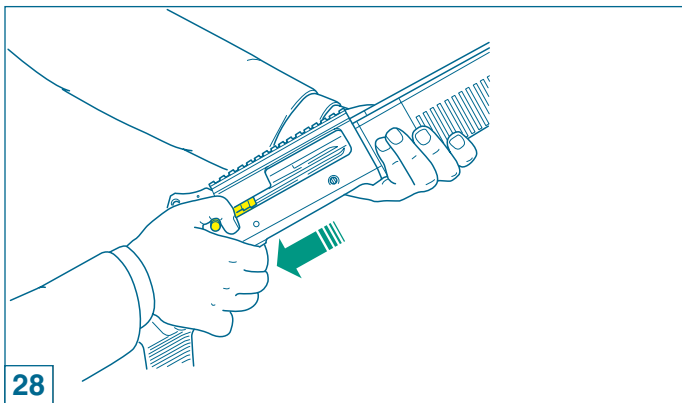

- 3) unscrew **the fore-end cap** (fig. 30);
- 4) remove **the barrel** along the magazine tube (fig. 31);
- 5) slide down **the twin forearms** (fig. 32);
- 6) **grip the barrel** and move it forward to remove the whole barrel-breech unit from the receiver (figs. 33-34);
- 7) hold **the bolt handle firmly** and press **the carrier button** (fig. 35), allowing the bolt to move a little way forward until it stops (fig. 36);

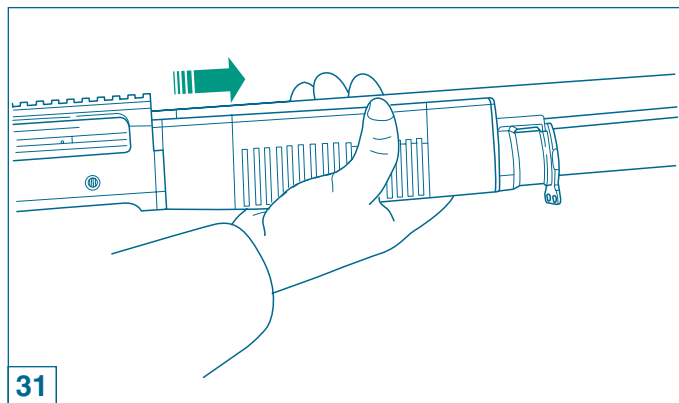
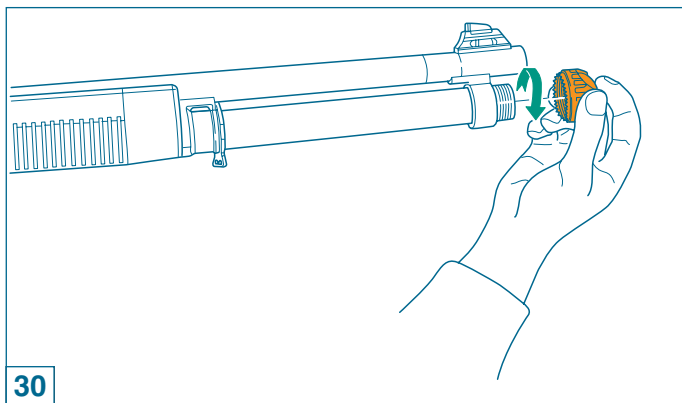

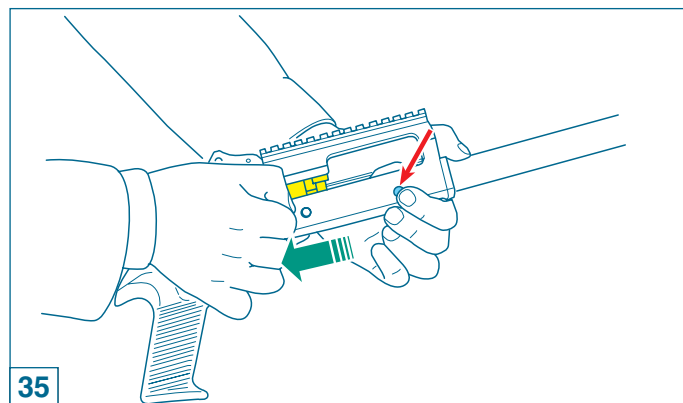
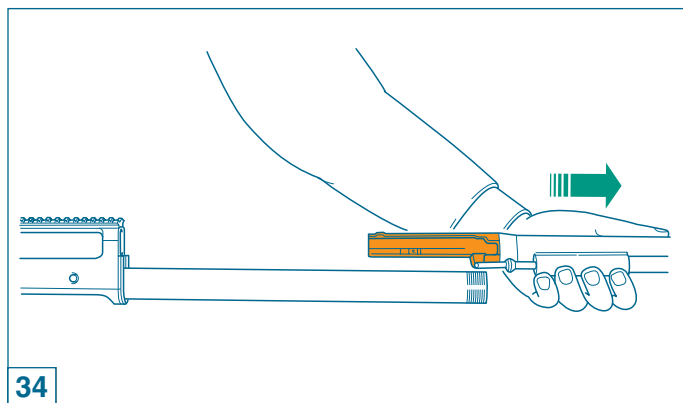
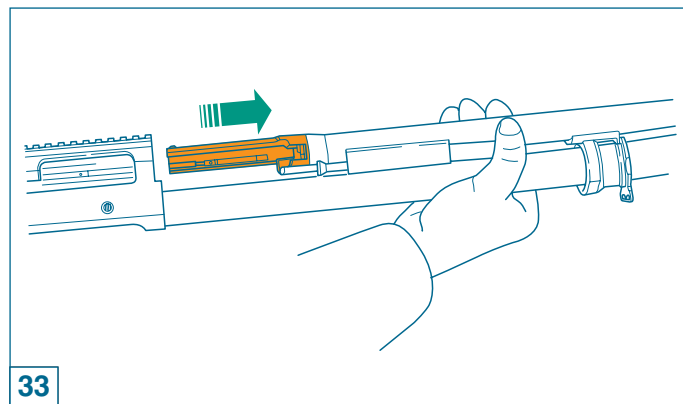
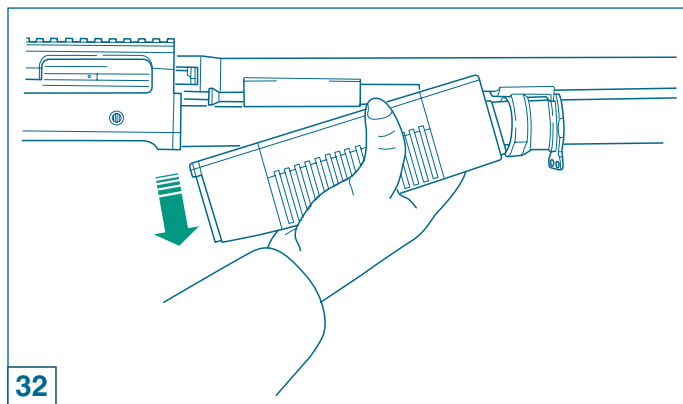

- 8) twist and pull off **the bolt handle** (fig. 37);
- 9) remove **the bolt assembly** from the receiver, pulling it forward (fig. 38);
- 10) remove **the firing pin stud** from the bolt assembly, ensuring that the firing pin and the relative **return spring remain inside** the bolt (fig. 39);
- 11) remove **the firing pin** and the **firing pin spring** (fig. 40);
- 12) remove **the locking head pin** from its seat (fig. 41);

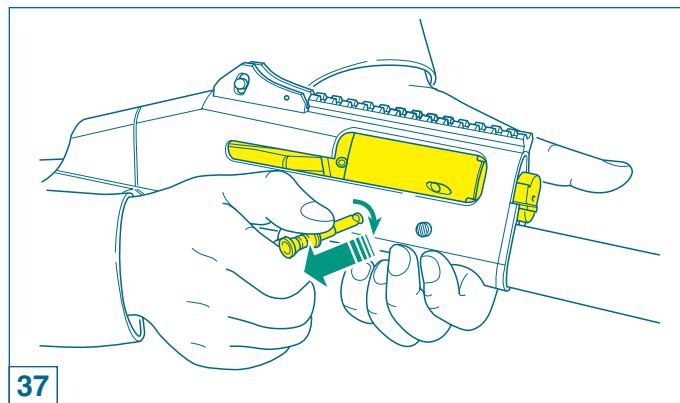
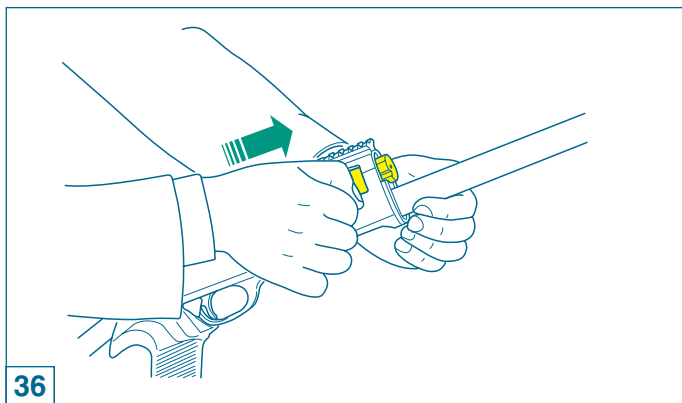

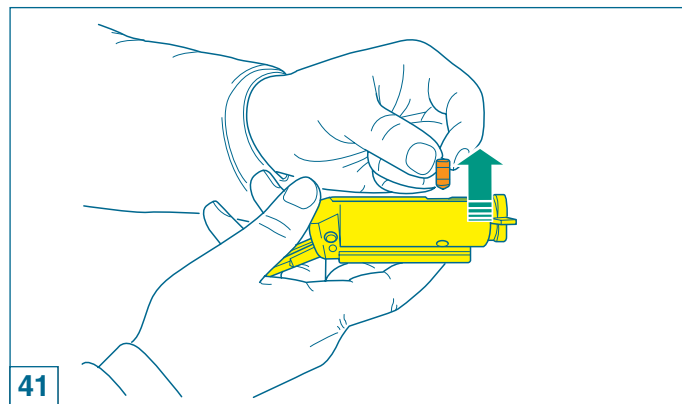
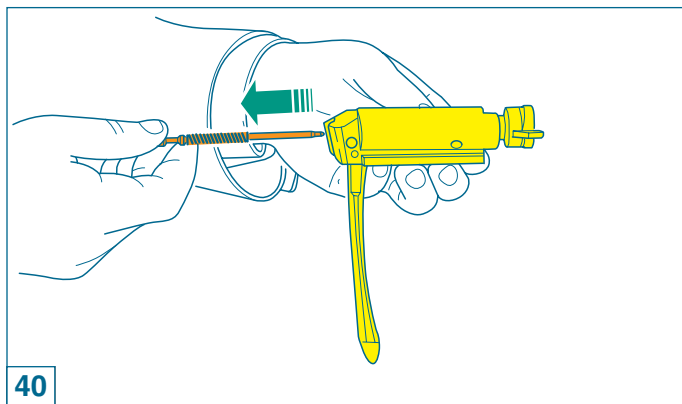
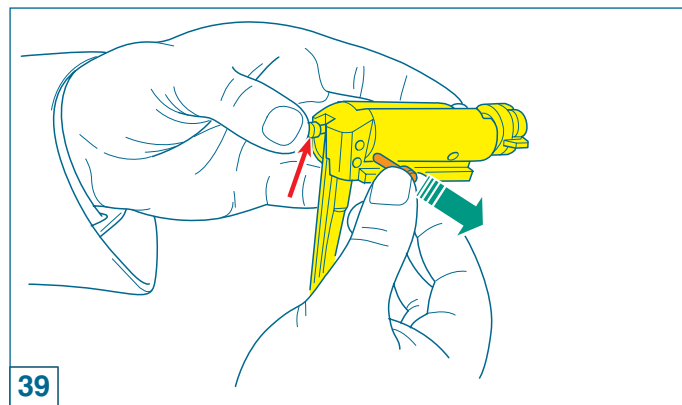
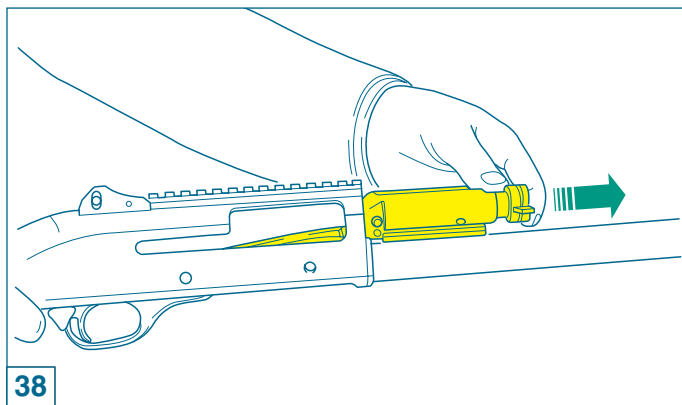

- 13) remove **the locking head** (fig. 42);
- 14) extract **the axle bush** from the stock-receiver unit, pushing it with the point of the firing pin (fig. 43);
- 15) **pull out the axle bush** using the large end of the bolt handle (figs. 44-45);
- 16) press **the carrier button** and extract **the trigger group** towards the front (fig. 46);

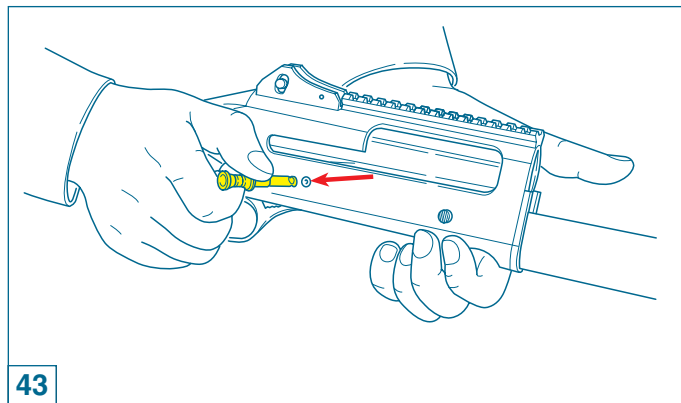
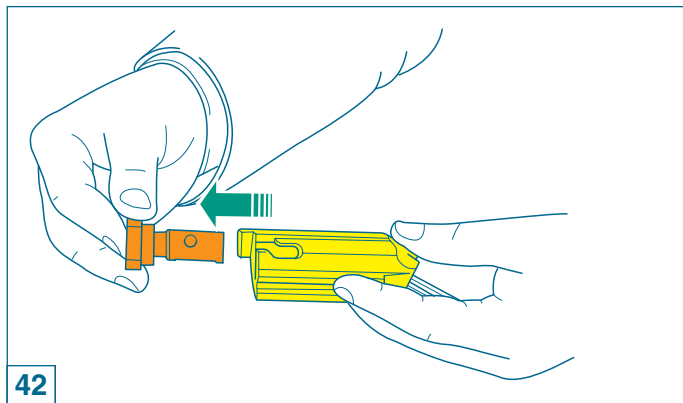

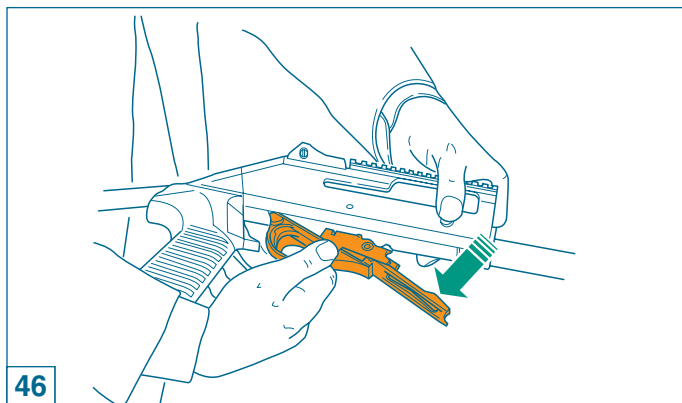
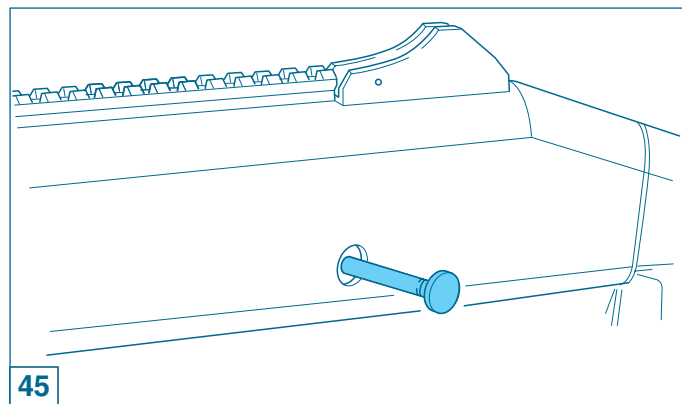
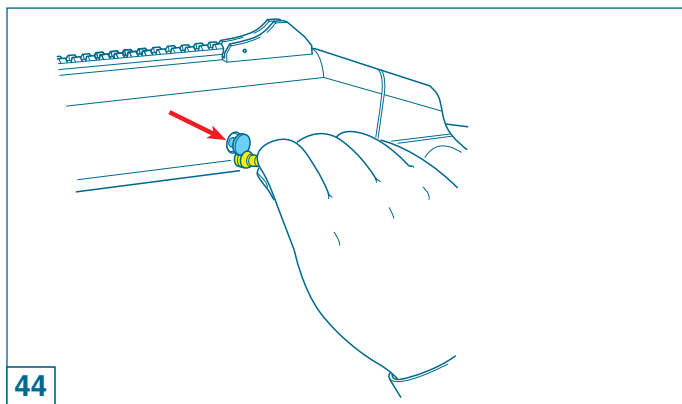

- 17) **starting with the telescoping stock extended:**
 - a) depress **locking button**;
 - b) rotate the stock **clockwise** (rear view);
 - c) push it forward till **the line** marked on the recoil tube (fig. 47);
 - d) rotate the stock **counter-clockwise**;
 - e) pull it to the rear off the recoil tube (figs. 48-49);
 - 18) take the receiver with a hand and with the other unscrew the **pistol grip** in a **counter-clockwise** direction until free (fig. 50).
 - 19) using the bolt handle, remove **the gas cylinder plugs** (fig. 51);
 - 20) remove **the gas pistons** from the front end (fig. 52);
- The gun is now completely stripped: the parts to be inspected and cleaned are all separated.

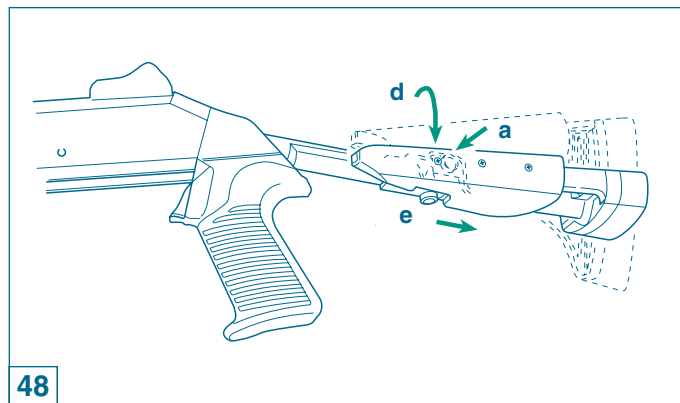
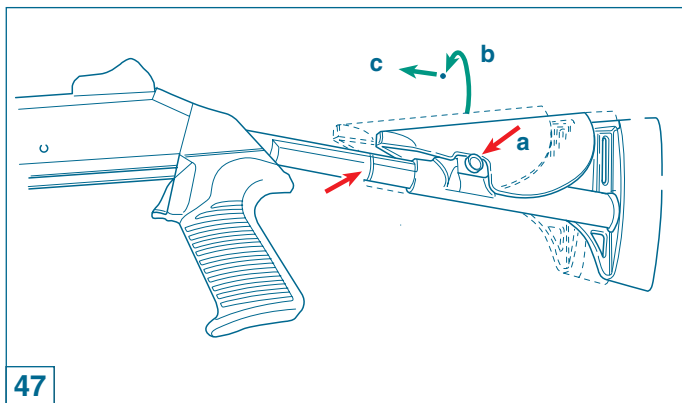

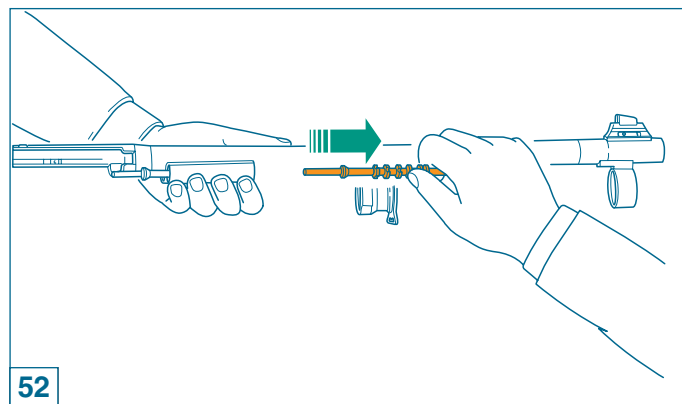
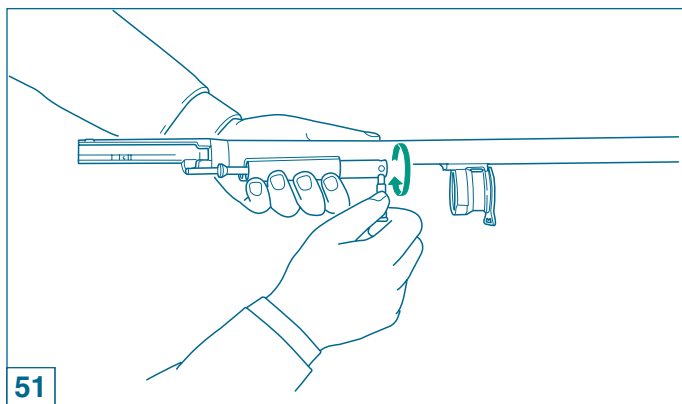
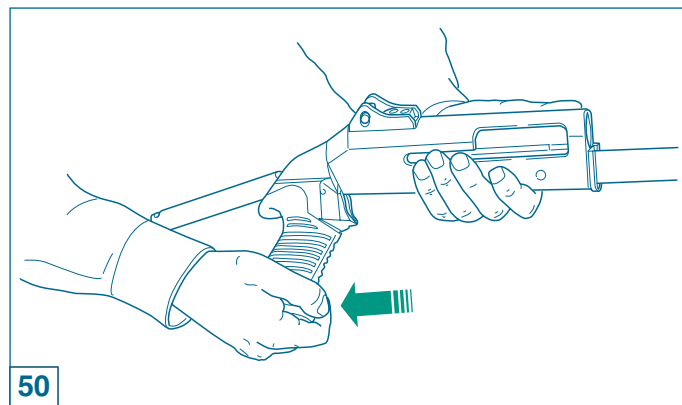
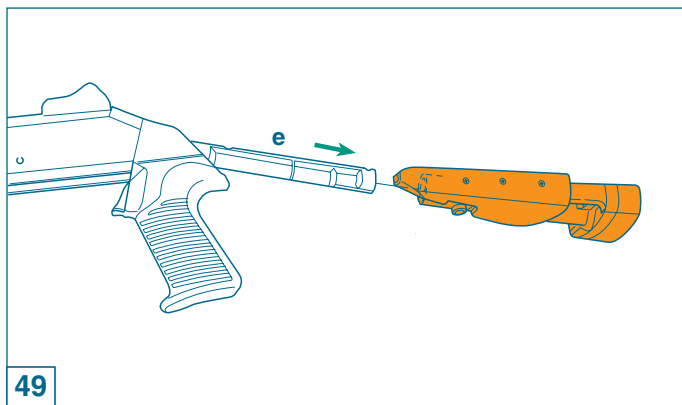

Firearm cleaning

Because of their construction simplicity and correct choice of materials, Benelli shotguns **do not require** any particular maintenance intervals. The following **is recommended** however:

- 1) a normal **cleaning** of the barrel after use;
- 2) periodically clean powder or foreign residues from the trigger assembly (trigger, hammer, etc.), and then lubricate them;
- 3) disassemble, clean and lubricate **the bolt group**;
- 4) according to the ammunition type used, periodically **dismantle and clean the gas cylinders and gas cylinder pistons**.

NB: the gas system must not be lubricated.

- 5) to keep the gun in good order, oiling **of the parts** subject to atmospheric corrosion is recommended.

NB: all barrels are internally **chromium plated**.

Shotgun assembly

For correct assembly of the gun proceed as follows:

- 1) install gas pistons (fig. 55). Using the bolt handle, screw gas plugs into cylinders (fig. 56);

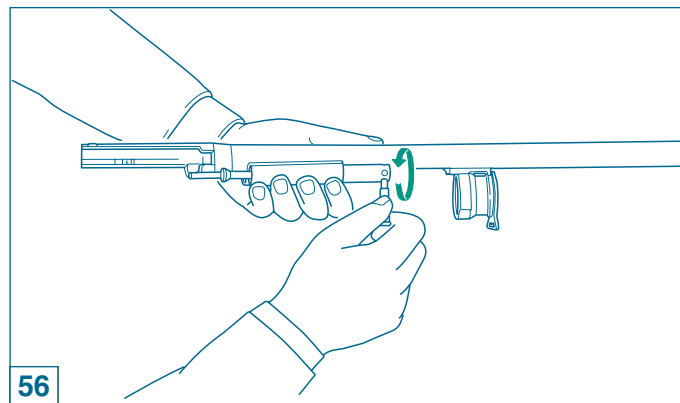
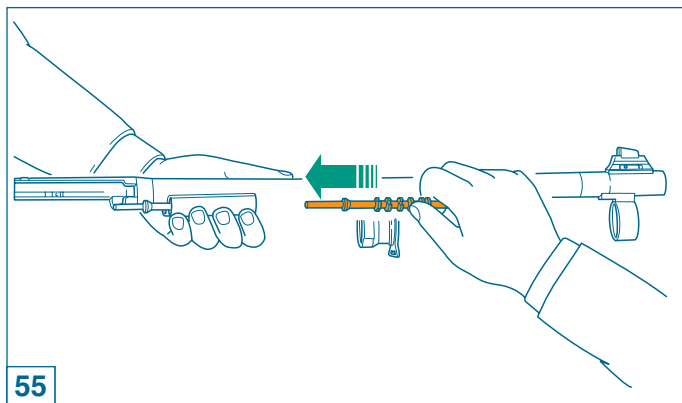

- 2) rotate **the pistol grip** onto the receiver (clockwise direction from rear sight) (fig. 57) until it is against the back end of the receiver; then **align** it with the receiver (max are additional turn);
- 3) install **the telescoping stock** (figs. 58-59), following in the reverse sequence of which it was disassembled;
- 4) lift the **stock-receiver** group as far as **the receiver** and press **the carrier button**, insert **the complete trigger group - with cocked hammer** - on the receiver in slightly forward position, then draw it back **until engaged** in the rear of the receiver itself (fig. 60);
- 5) insert the **axle bush** into the hole for it (fig. 61);
- 6) insert **the bolt head** into the front of the bolt carrier (**the hole** on its leg must be aligned with **the slot** of the bolt) (fig. 62);

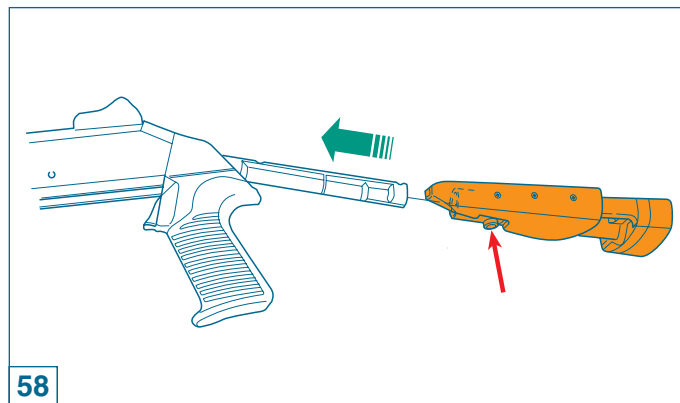
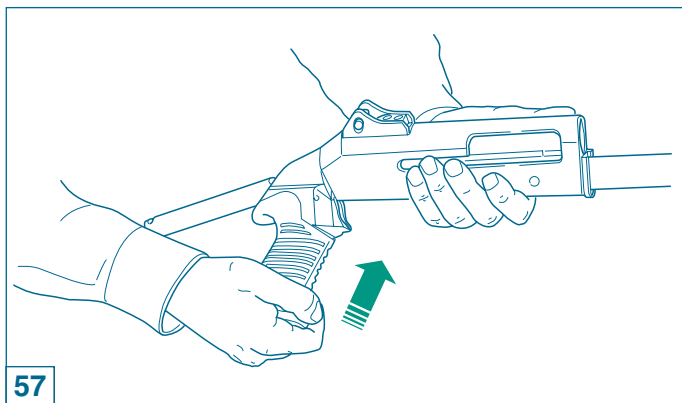

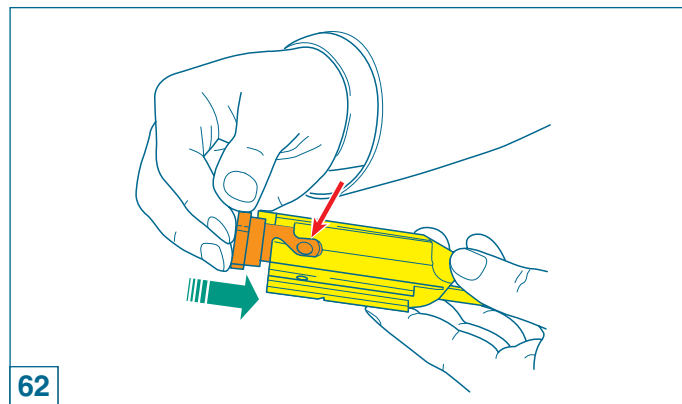
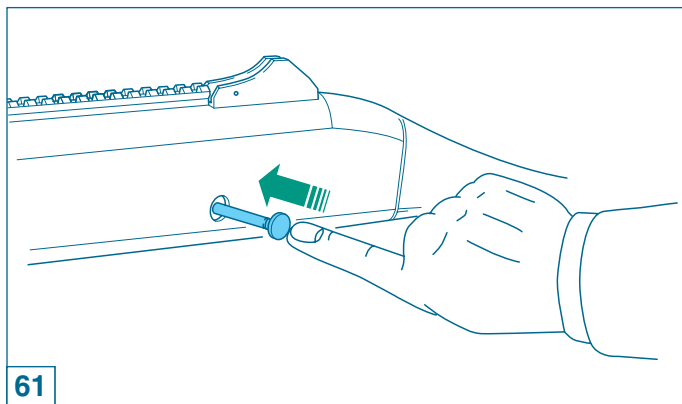
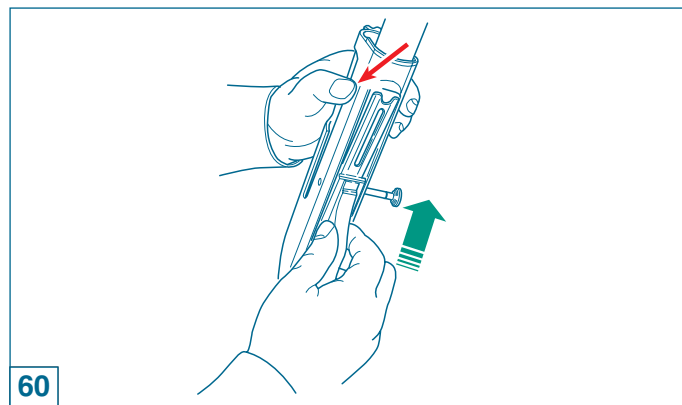
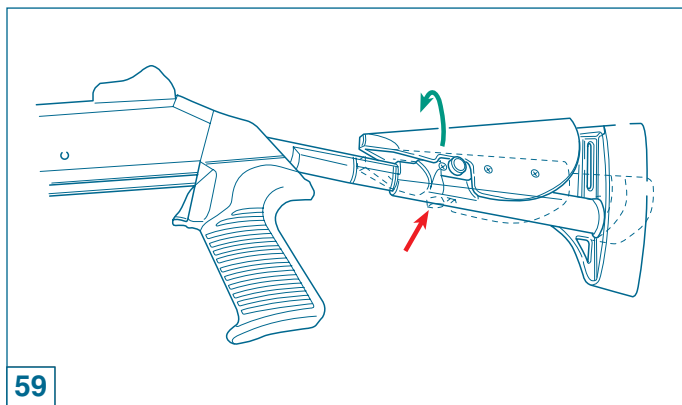

- 7) insert **the locking head pin** in its hole on the locking head's stem, through the slot on the bolt (fig. 63);

NOTE: the reference **line** on the top of the pin is **visible and aligned** with the bolt centerline.

- 8) insert **the firing pin** and the firing pin **spring** inside the bolt (fig. 64);

NOTE: **always** make sure that the firing pin has been inserted together with its spring.

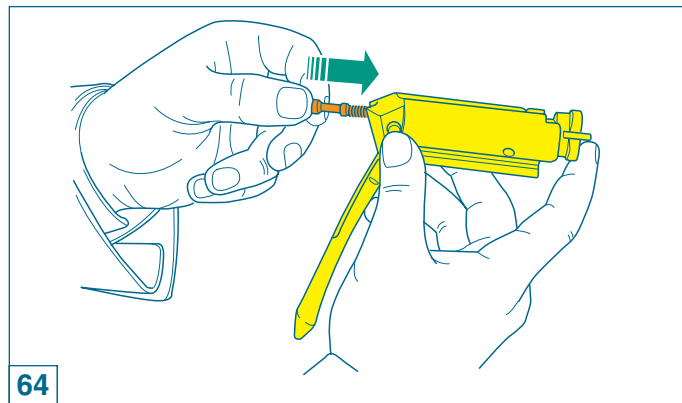
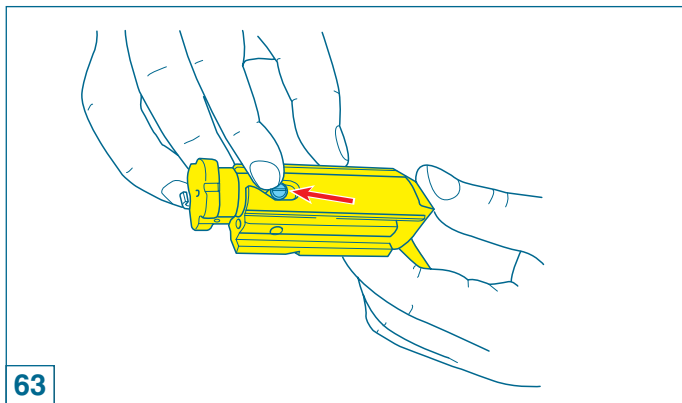

9) insert **the locking pin** stud in its seat (fig. 65);

WARNING: if **firing pin** and relative **locking pin** have been correctly assembled, at the end of the operation the firing pin **will appear** as described under fig. 66.

NOTE: do not use **any tools** to insert the firing pin into the bolt carrier: **use fingers only.**

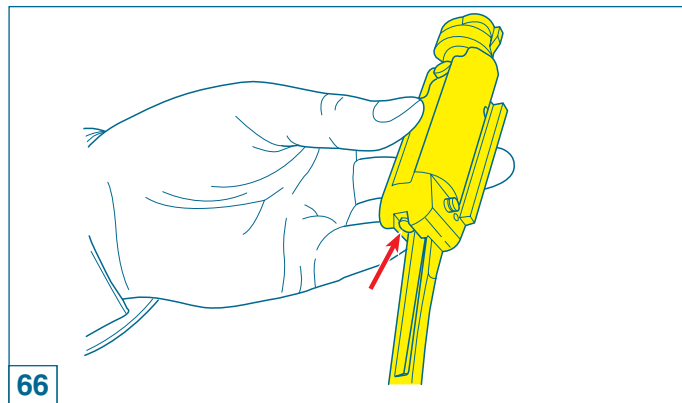
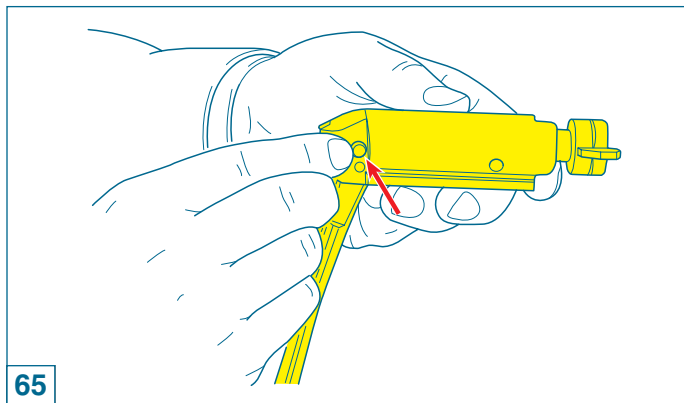

- 10) hold the stock receiver almost horizontally and insert **the bolt assembly** in its guide on the receiver (fig. 67);
- 11) insert completely **the bolt handle** into the bolt group (fig. 68);

WARNING: make sure that **the link** slides over the trigger guard assembly and onto **the recoil** spring plunger inside the receiver once the bolt assembly is fully mounted (fig. 69).

- 12) open **the bolt** (fig. 70);
- 13) press **the cartridge drop lever** (fig. 71).

Complete gun reassembly by following procedures listed from point 4 at page 11 "Assembly procedure".

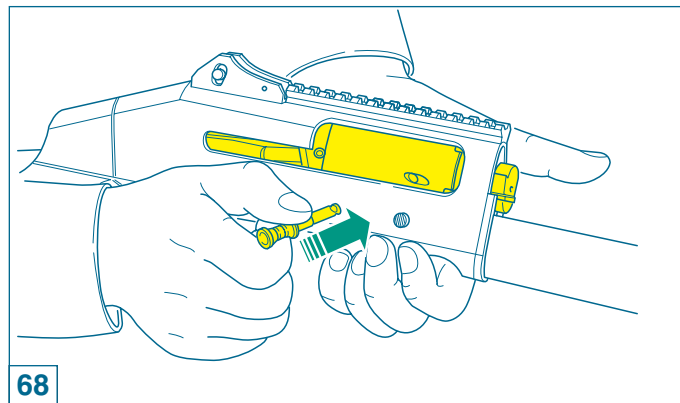
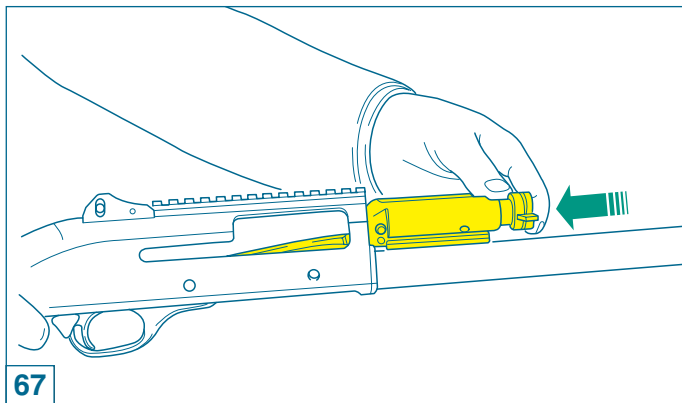

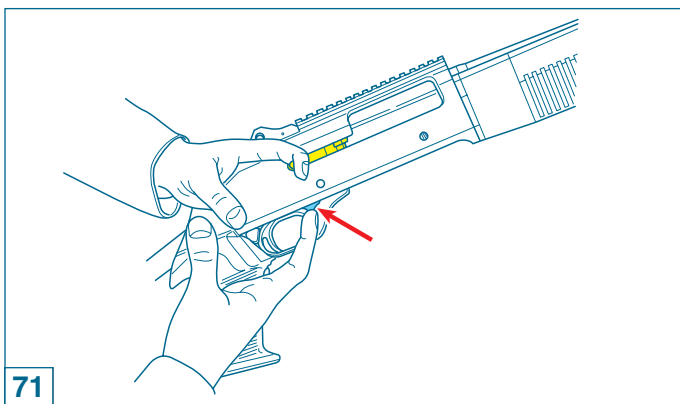
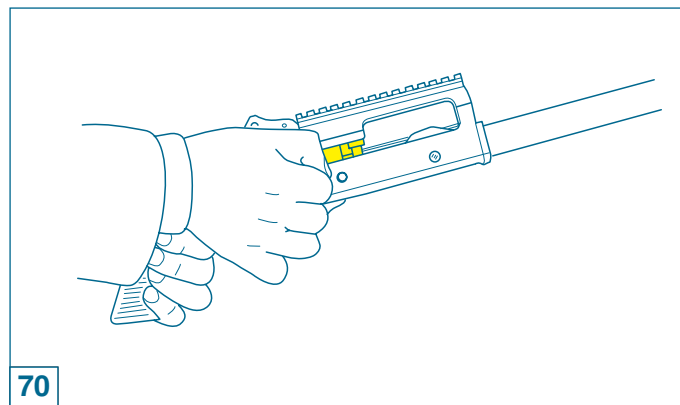
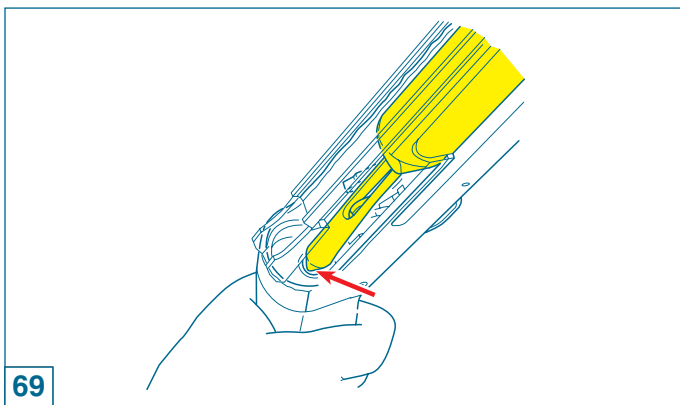

Trouble shooting

The gun fails to fire

- 1) **check the safety catch:** if it is engaged, shift the button to the fire position (pag. 7);
- 2) **check that there is a cartridge in the barrel.** If not, insert a cartridge following the loading instructions (pag. 8);
- 3) **check the firing mechanism.** If necessary, clean and lubricate it.

Magazine cap

- 1) Especially after the first rounds, check that **the magazine cap** is firmly tightened, to keep **the barrel** against to the receiver.

*The chrome barrel extension **must be** completely contained by the receiver. None of the chromate parts must be visible at the front of the receiver (fig. 8).*

Choice of ammunition

M4 can use 12 ga. shells with 70 mm (2" 3/4) or 76 mm (3") cases.

NOTE: never use cartridges with a case **longer than** the chamber, **as this would have serious consequences for both the gun and shooter.**

No adjustment to the shotgun is necessary to fire any of the ammunition listed above.

All Benelli shotguns are subjected to a 1370 bar burst test at the Italian National Proof House in Gardone Valtrompia (Brescia).

Rear sight adjustment

The rear sight can be adjusted for both windage and elevation if the standard factory setting does not meet shooter requirements.

Before attempting any work on your M4 make sure that the chamber and the magazine of your shotgun are unloaded.

See the instructions on loading and unloading on pages 8-13.

Windage adjustment

Using a coin or the rim of a shell cartridge to rotate the **windage adjustment screw** (fig. 72), located on the right side of the rear sight assembly, in the desired direction.

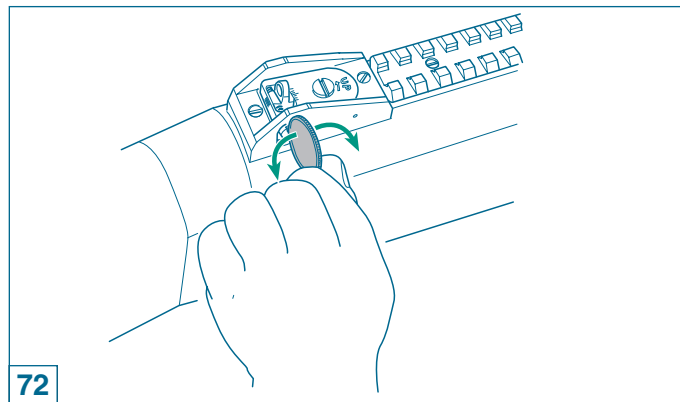

Rotating the windage adjustment screw in a **counter clockwise** direction moves the point-of-impact on target to the left, in a **clockwise** direction moves the point-of-impact to the right. **Note on the windage scale**, the amount of adjustment made (fig. 73).

Elevation adjustment

Use a coin or the rim of a shell cartridge to rotate the elevation adjustment screw (fig. 74), located on top of the elevating platform, in the desired direction.

Rotating the elevation **screw** in a counter clockwise direction raises the aperture and the point-of-impact of on target, in a clockwise direction lowers the aperture and point-of-impact on target. Note on the elevation scale on the rear surface of the elevating platform the amount of adjustment made, or count the tactile clicks of the screw.

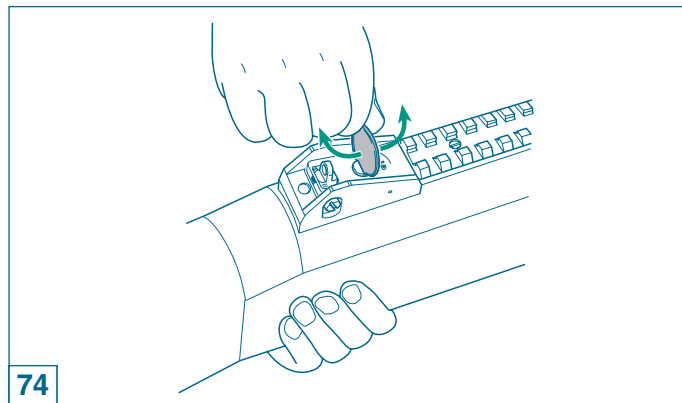
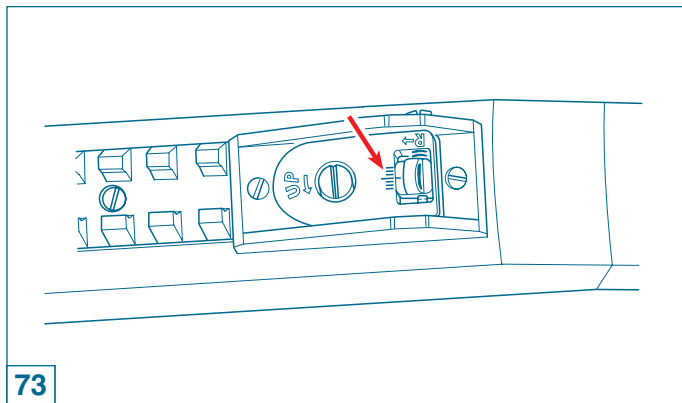

Internal choke (when supplied)

Before attempting any work on your M4 make sure that the chamber and the magazine of your shotgun are unloaded. (See the instructions on loading and unloading on pages 8-13).

To change or clean the internal choke, proceed as follows:

- 1) **unscrew** the internal choke using the special **choke wrench** supplied with the shotgun and extract it completely from the barrel seat (fig. 75);
- 2) if the threaded seat of the choke on the barrel **is too dirty**, clean it by spinning round the **threaded part** of the proper wrench (fig. 76);

NOTE: before re-using the shotgun, **make sure** that the choke wrench has been removed from the barrel's muzzle.

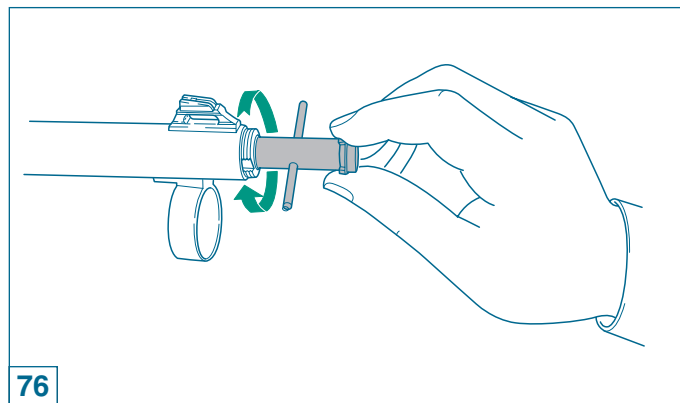
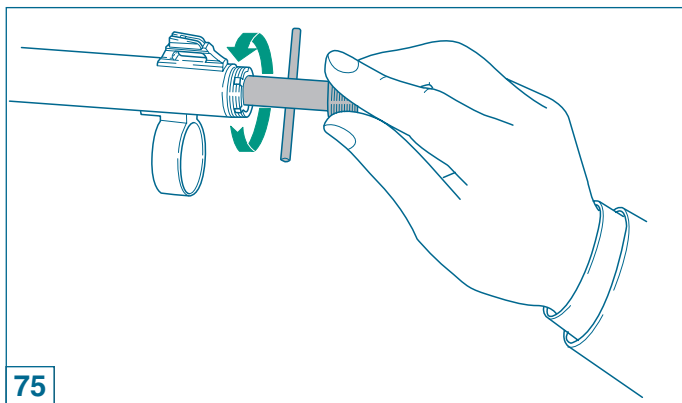

- 3) Reassemble on the barrel seat the kind of choke required, taking care to **insert the non-threaded part** inside the barrel, before screwing the choke on the barrel's thread (fig. 77).

NOTE: the choke correctly mounted **must not stick out** of the barrel's muzzle.

- 4) Finish the assembly of the choke by screwing it firmly using the choke wrench (fig. 78).

NOTE: before re-using the shotgun, make sure that the choke wrench has been removed from the barrel's muzzle.

Before the shotgun is put away, cleaning the internal choke and relative barrel thread is recommended.

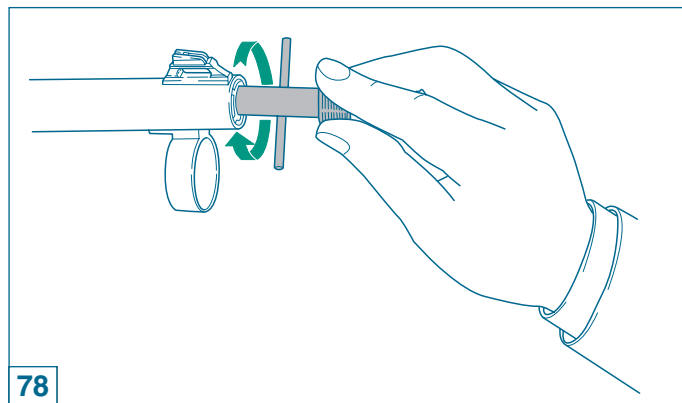
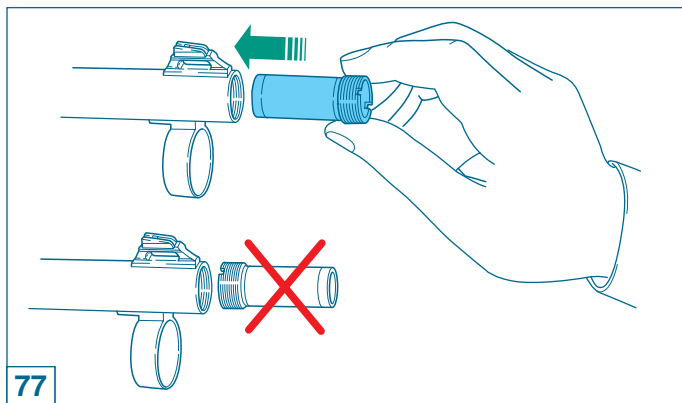

Benelli choke tubes are marked for easy identification. Notches on the muzzle end of each tube allow for quick recognition, even when the choke tube is installed in the shotgun.

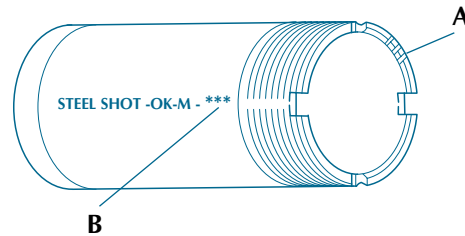

A NOTCHES
B SYMBOL

NOTCHES	CHOKE	SYMBOL	STEEL SHOT
I	Full	X	NO
II	Improved Modified	XX	NO
III	Modified	XXX	OK
IIII	Improved Cylinder	XXXX	OK
IIIII	Skeet	XXXXX	OK

Three round limiter

Before attempting any work on your M4 make sure that the chamber and the magazine of your shotgun are unloaded. (See the instructions on loading and unloading on pages 8-13).

WARNING

The magazine spring must be captured by hand when disassembling the gun to prevent the spring from escaping at a high velocity.

Wear eye protection when disassembling this gun!

If the magazine spring escape at high velocity severe eye injury or other injuries can occur.

To install the limiter, proceed as follows (figs. 79-80):

- 1) **with the gun unloaded**, point the barrel upwards and unscrew **magazine cap** from the front of the weapon;
- 2) using relative pliers, remove **magazine spring seal ring**;
- 3) insert **the limiter** in the spring;
- 4) insert **limiter** and spring into the receiver (magazine tube);
- 5) install **the spring seal ring**: check for protrusion;
- 6) screw the magazine cap onto the end of the magazine tube and **fastening** the whole barrel-breech-fore-end unit **tightly**.

